



GRC FIXINGS

03¹

CONTENTS

Glass Fibre Reinforced Concrete Fixings	3.1-03
Technical Data	3.1-04
Special Applicatons	3.1-05
GRC Cladding Panel Projects	3.1-07



GLASS FIBRE REINFORCED CONCRETE FIXINGS

Glass fibre-reinforced concrete (GRC) is a lightweight, strong and durable material, which is widely used for cladding panel, rain screen, tunnel wall covering manufacturing or other architectural structures.

GRC Product Ranges

CFS has considerable experience in supplying specialist lifting and fixing details for the GRC industry. Products are available for lifting, fixing support and restraining GRC. CFS is the dedicated construction partner for bigHead® who have the following dedicated range for GRC.

What are the benefits of bigHead® designs?

- The unique bigHead® design allows GRC panels to be as thin and light as possible with no additional material required for fixing the bigHead® “anchors”
- bigHead®s are inserted into the GRC material during the manufacturing process, removing secondary fixing processes, saving assembly time and preventing on-site assembly mistakes
- bigHead®s are discrete, being only visible from one side
- bigHead®s are corrosion resistant, made of 316 grade stainless steel
- bigHead®s withstand very high loads
- bigHead® design versatility maximises GRC design freedom without compromising strength or quality



Standard Size Range

Part No	Thread size	Anchor depths available (mm)
CFS-BH-F2/B32-M6x10 (SS)	M6	10
CFS-BH-F2/B32-M8x10 (SS)	M8	10
CFS-BH-F2/B32-M10x20 (SS)	M10	20

Other lengths available to order
SS = available in stainless steel

Technical Data

Thickness	Tension	Shear
15mm	0.25kN	0.4kN
40mm	1.0kN	1.25kN
80mm	1.0kN	1.25kN

For single bigHead® fixings M6 x 10 loads derived with a 4.5:1 factor of safety. Users should check that fixing screws used have adequate shear, tension and bending capacity.

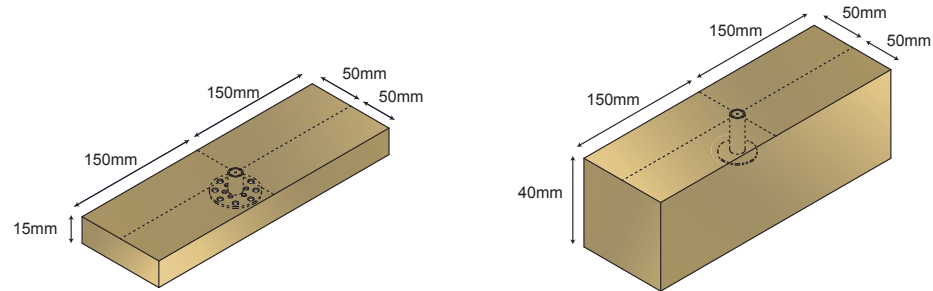

M6 / M8 / M10

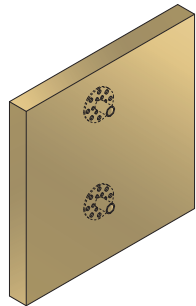

10mm:
Thin sections

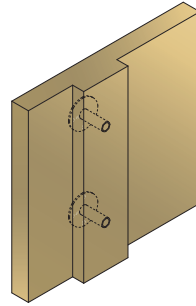

SL-FS-ZN-M12 or
SL-FS-A4-M12
ETA Stud Anchor

Special Applications

SL-FS-ZN-M12 or SL-FS-A4-M12 ETA Stud Anchor



For use in high load applications please consult CFS.
M12 and M16 sizes available

Cast In Channels



Shallow
depth

Available with shallow anchors to suit GRC sections

Flex Anchors Restraint

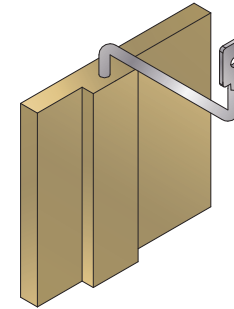

To accommodate thermal movement of GRC

Support Brackets & Framing Systems

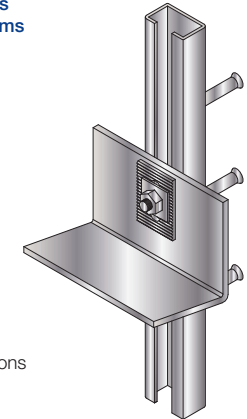

Designed and
manufactured to
suit your applications



Toothed Channel insert for GRC Flat Panels

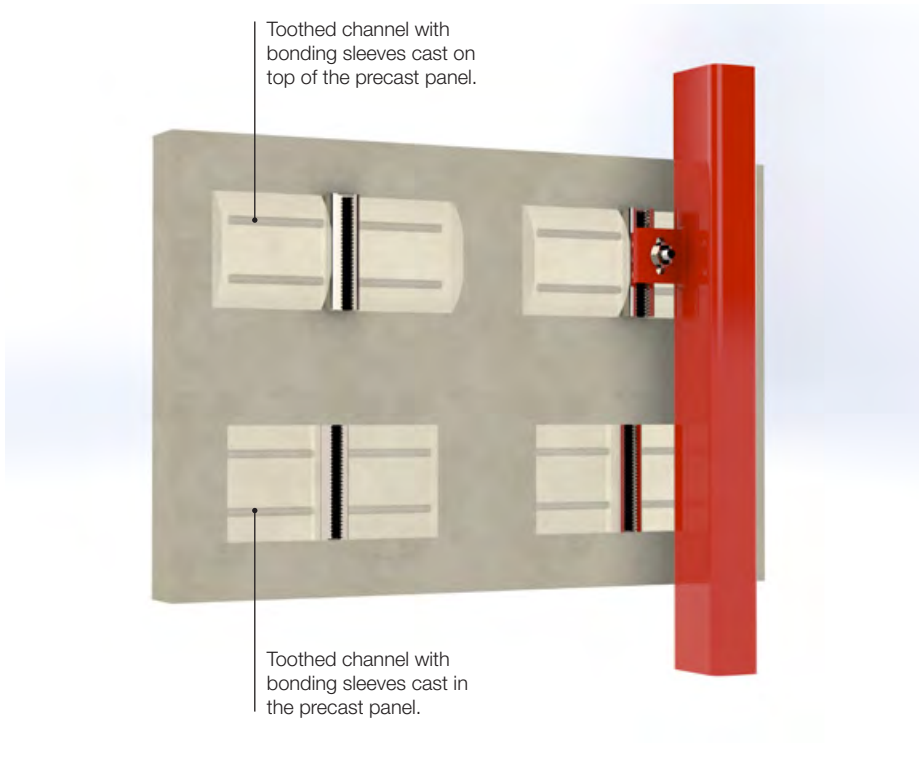
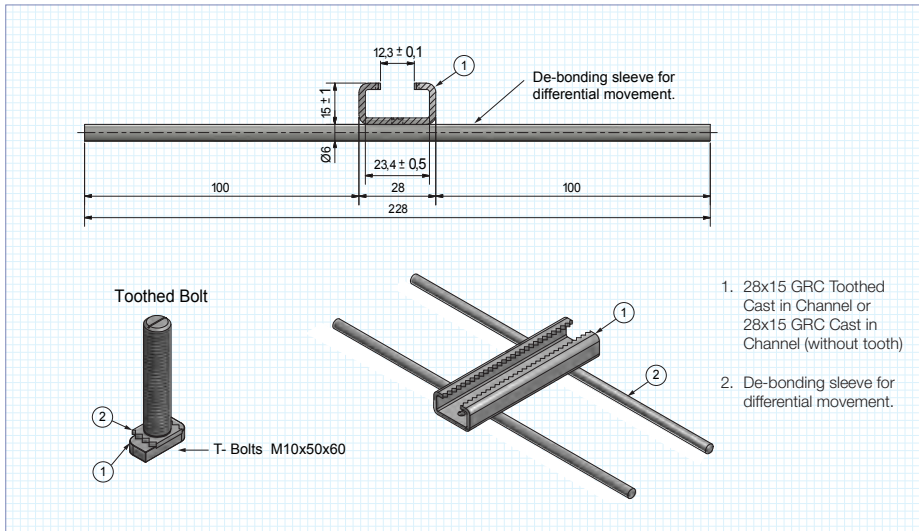

GRC CLADDING PANEL PROJECTS

